



Applying for a grant as an **ELIGIBLE ENTITY**

DEAN BRUCE AND KATIE CRAYTON,
CO-LEADS OF NMDA'S HEALTHY SOIL PROGRAM

Welcome and Housekeeping

We invite you to introduce yourself in the Chat, noting:

- the name of your Eligible Entity (*Pueblo of Acoma, Acequia del Caño, Town of Tomé Land Grant, Ciudad SWCD, San Juan County Extension, etc.*)
- whether your jurisdiction contains more cropland, rangeland, or another land type

During the presentation, please stay on Mute, keep your Video off, and type questions in the Chat

After the presentation, you can use the Raise Hand feature, then unmute to ask your question

These slides and a captioned recording will be posted soon on our Eligible Entity web page



Today's Agenda

- ❑ An overview of the grant-application cycle

- ❑ A quick refresher on...
 - ❑ Who and what projects are eligible
 - ❑ When and where projects can happen

- ❑ How to apply following our step-by-step process online

- ❑ Questions & Answers

WHO is eligible to apply for NMDA's Healthy Soil Program grants?

We welcome applications from two (2) applicant types

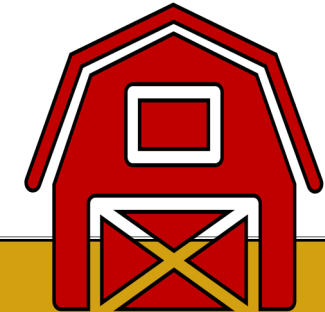

1. ELIGIBLE ENTITIES

- New Mexico’s “local **governmental** [entities] with proven land management capacity to support healthy soil”, including:
 - Pueblos, tribes, and nations
 - Acequias
 - Land grants
 - Soil and water conservation districts (SWCDs)
 - NMSU Cooperative Extension Service
 - Other parties meeting the Eligible Entity definition above
- **Application period:** January 15-March 19, 2025
- **Awards of up to \$100,000.00** (including mileage + 15% administrative fee, both of which NMDA pays to the Eligible Entity itself)

2. INDIVIDUAL APPLICANTS

- New Mexico’s **non-governmental** parties that are directly engaged in farming, ranching, or another form of land management:
 - Individuals
 - Businesses
 - Nonprofits
- **Application period:** January 15-March 19, 2025
- **Awards of up to \$24,999.99** (including mileage + 15% administrative fee, both of which NMDA pays to the Individual Applicant’s Project Sponsor)

The webinar for INDIVIDUAL APPLICANTS happens today at 3 p.m.



WHERE can
Healthy Soil Program-funded projects
happen?

Healthy Soil Program projects can happen...

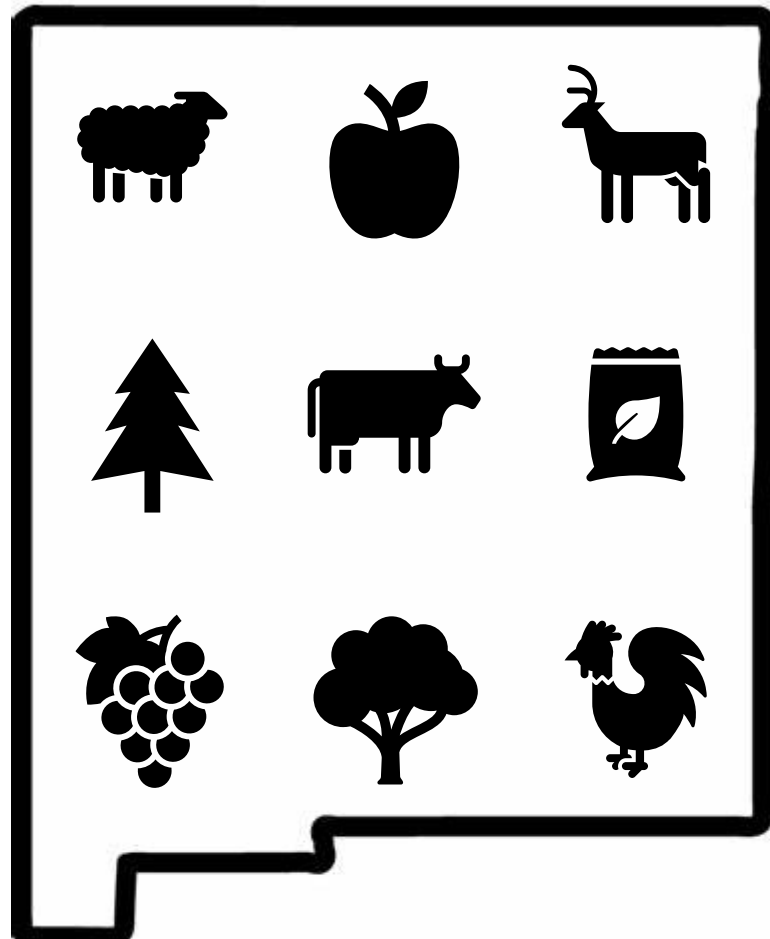

- Anywhere in New Mexico
- On any type of operation: cropland, rangeland, irrigated pasture, forest land, orchards, vineyards, gardens...
- Where there's an *existing* relationship to the land: either the Eligible Entity owns it, leases it, manages it on another's behalf, or partners with local landowners to perform work on it
 - Bottom line: **The Eligible Entity must have landowner permission** to implement a soil health project on land it doesn't own
- On any amount of land: Projects can be measured in acres or square feet

WHEN can
Healthy Soil Program-funded projects
happen?

WHEN NMDA's Healthy Soil Program grants happen

Projects can last **up to ~15 months**,
starting mid-July 2025 and ending September 2026

July 2025		August	September	October	November
December	January 2026	February	March	April	
May	June	July	August	September 2026	

WHAT projects are eligible for NMDA's Healthy Soil Program?

NMDA's Healthy Soil Program grants fund **on-the-ground projects** involving 1+ of the 5 soil health principles:

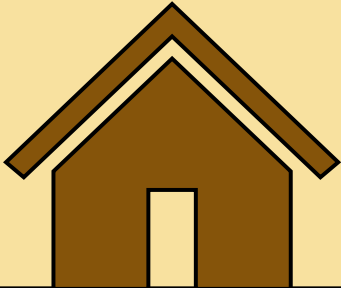
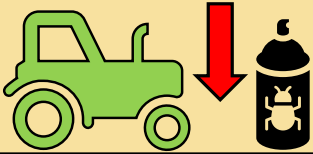
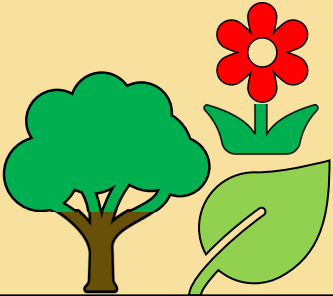
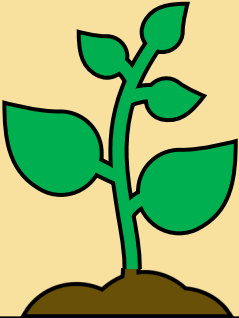
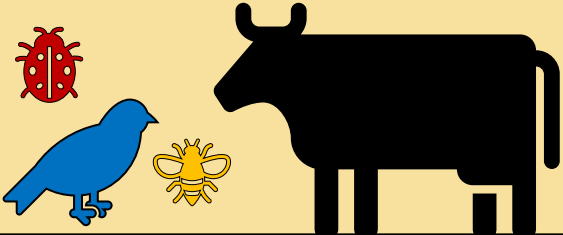
<p>1. Keep soil covered.</p> 	<p>2. Minimize disturbance on cropland and minimize external inputs.</p> 	<p>3. Maximize biodiversity.</p> 	<p>4. Maintain a living root.</p> 	<p>5. Integrate animals into land management, including grazing animals, birds, beneficial insects or keystone species, such as earthworms.</p> 	
<p>→ EXAMPLES of practices arising from the 5 soil health principles</p>	<ul style="list-style-type: none"> Planting a cover crop Leaving crop residues in the field to decompose Prescribed grazing to maintain cover on rangeland 	<ul style="list-style-type: none"> Minimizing tillage on cropland Minimizing farm inputs (applying the 4R strategy) 	<ul style="list-style-type: none"> Growing different plants Rotating crops Managing grazing to promote rangeland diversity 	<ul style="list-style-type: none"> Growing long-season crops Planting a cover crop following a short-season crop 	<ul style="list-style-type: none"> Planting pollinator habitat Grazing crop residues Following a prescribed grazing plan Following a bale-grazing plan

Sample projects funded on cropland



Sample projects funded on rangeland



SUBSOILING

To see where subsoiling has happened in the photo above, look for the areas parallel to **this red line**.

Photo courtesy Rangeland Solutions, LLC, Curry County, NM

INTENSIVE ROTATIONAL GRAZING
Photo courtesy CS Ranch Colfax County, NM



BALE GRAZING

Photos courtesy M-Scar Farm & Ranch, Colfax County, NM



Projects funded by the Healthy Soil Program, Fiscal Years 2020-2024 (FY20-24)

- = project led by an **Eligible Entity**
 (“local **governmental** entity with proven land management capacity to support healthy soil”)
- = project led by an **Individual Applicant**
 (**non-governmental** party directly engaged in farming, ranching, or another form of land management)

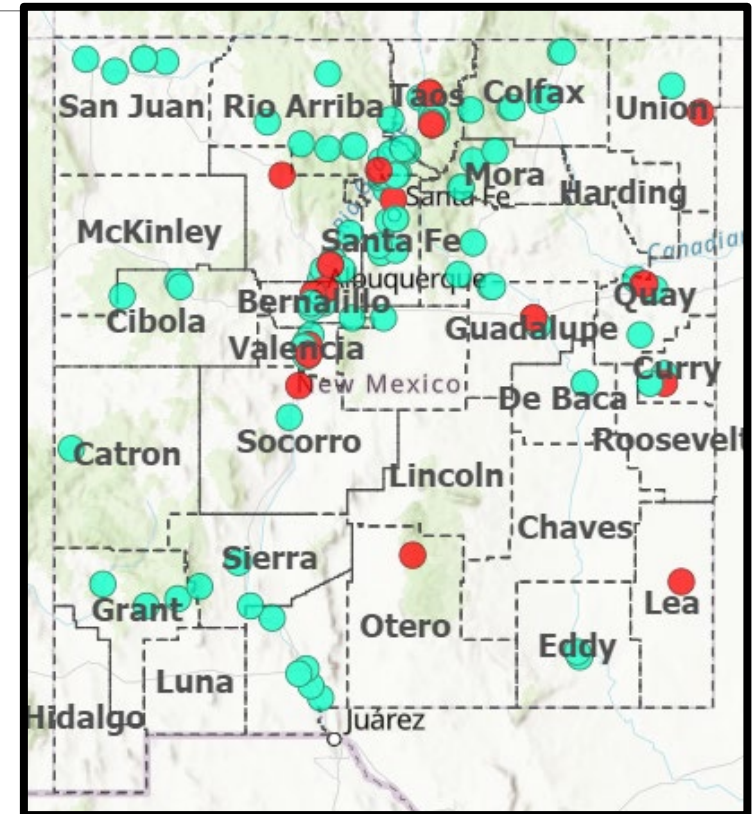

HOW does my Eligible Entity apply for a grant from NMDA's Healthy Soil Program?

The screenshot shows a web browser window with the URL <https://nmdeptag.nmsu.edu/hsp/requirements-for-eligible-entities.html>. The page header includes the NMDA logo and navigation links: ASSISTANCE PROGRAMS, FORMS & APPLICATIONS, LICENSING & REGISTRATION, INSPECTIONS, and STATUTES & RULES. The main heading is 'FY26 Requirements for Eligible Entities'. The text on the page describes eligible entities and provides application instructions, including a deadline of March 19, 2025, and a pre-application webinar on February 7, 2024. At the bottom, there is a table of application steps:

Application Document Checklist	-
Step 1. Select the project site(s) and identify the top soil health-related resource concern(s).	-
Step 2. Develop your project.	-
Step 3. Work on the online application.	-
Step 4. Finalize and submit the online application.	-

Everything you'll need to apply as a local governmental entity is on the **ELIGIBLE ENTITY** webpage - just follow **Steps 1-4**.

How to approach the step-by-step application process for **ELIGIBLE ENTITIES**

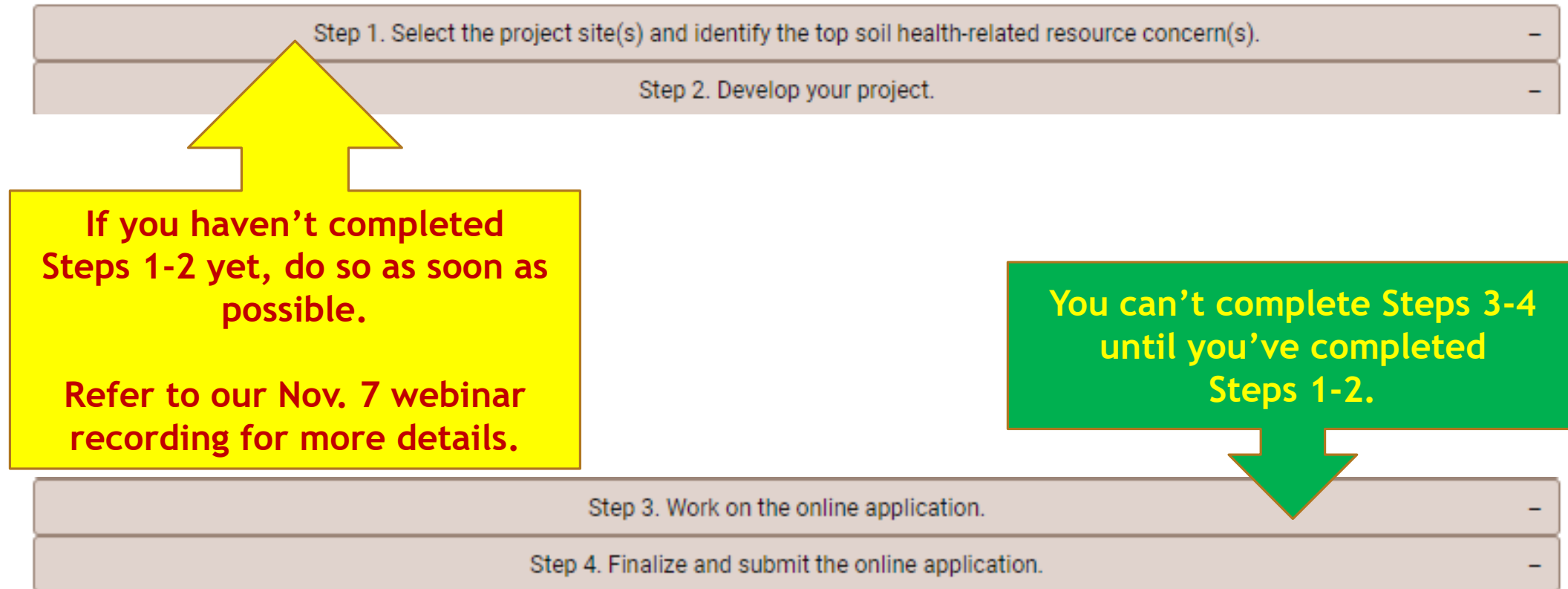

The steps and materials on the **Healthy Soil Program** webpage for **ELIGIBLE ENTITIES**

Scan this QR code to go to the webpage for **ELIGIBLE ENTITIES**



Overview: FY26 grant-application cycle timeline

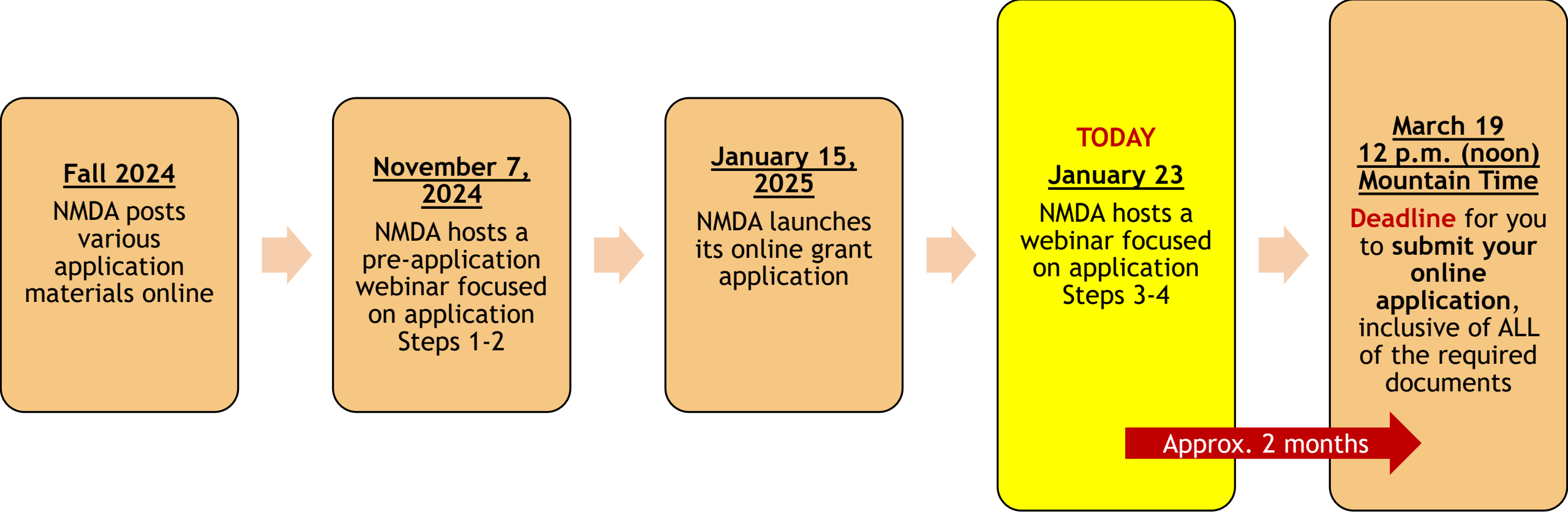

Tips and Reminders

TIPS	REMINDERS
<ul style="list-style-type: none"> • Build your project based on what your <i>soil</i> needs, not what <i>the Eligible Entity</i> needs. Let your soil health-related resource concerns, not the goods and services you hope to buy, guide the development of your project idea. • Don't outsource your application. Grantees are expected to be intimately familiar with all aspects of their projects. Allowing someone else to complete your application for you could set up the Eligible Entity for project failure. 	<ul style="list-style-type: none"> • Deadline to submit your online application, including all related documents: March 19 @ 12 p.m. (noon) Mountain Time • Late, incomplete, and paper applications will not be accepted for review. • NMDA is available to answer your questions until the application deadline. We recommend not waiting until the last minute, and we recommend emailing us (hsp@nmda.nmsu.edu) so that you have answers in writing.

Questions?



Visit our website to learn more and to subscribe to our weekly e-newsletter featuring application tips and deadline reminders, as well as soil health events, news, etc.

<https://nmdeptag.nmsu.edu/healthy-soil-program.html>



hsp@nmda.nmsu.edu
575-646-2642